

# G-CONNECT

DESK TO CREDENZA TOP  
ASSEMBLY INSTRUCTIONS

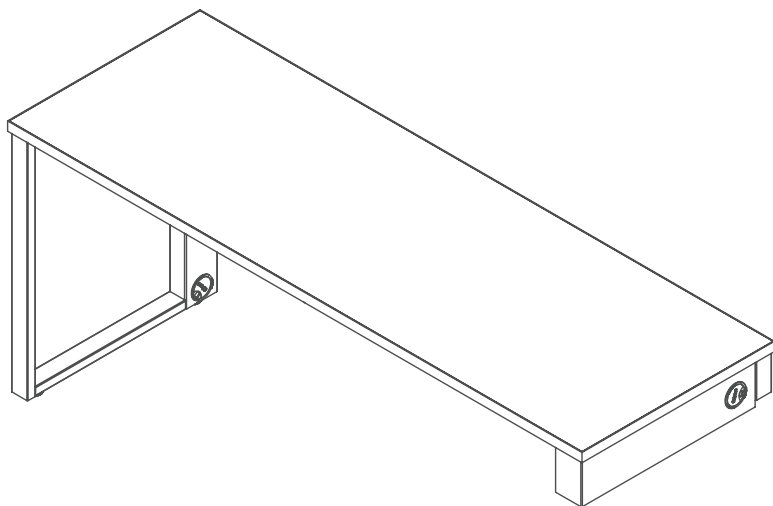

**Gebesa**  
CREATING AMAZING SPACES

Questions?

Call Toll Free 1-844-2GEBESA or email [warranty@gebesa.com](mailto:warranty@gebesa.com)

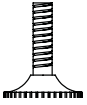

(G)  
Leveler  
1" x 1/4"

2x

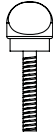

(H)  
Hand bolt  
1/2" x 1/4"

4x

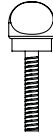

(I)  
Hand bolt  
1 1/2" x 1/4"

1x

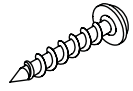

(J)  
Wood screw  
8 x 1"

10x

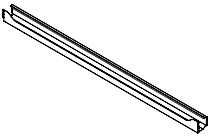

(B)  
Front duct

1x

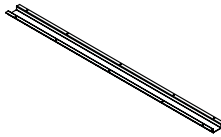

(F)  
Worksurface stiffener

1x

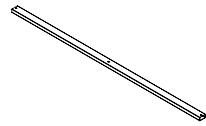

(C)  
Structural stiffener

1x

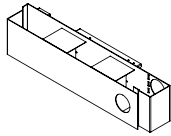

(E)  
Lateral duct

1x

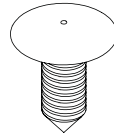

(K)  
Plastic screw

2x

REQUIRED ASSEMBLY TOOLS  
NOT INCLUDED



Screw driver

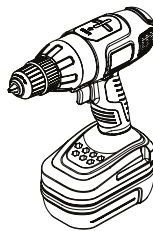

Drill

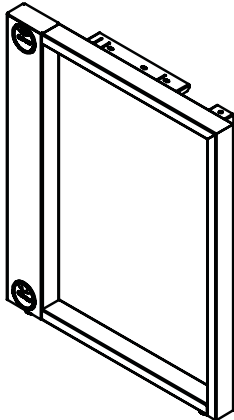

(A)  
"O" leg  
1x

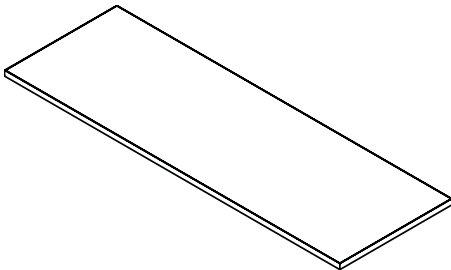

(D)  
Worksurface  
1x

1.

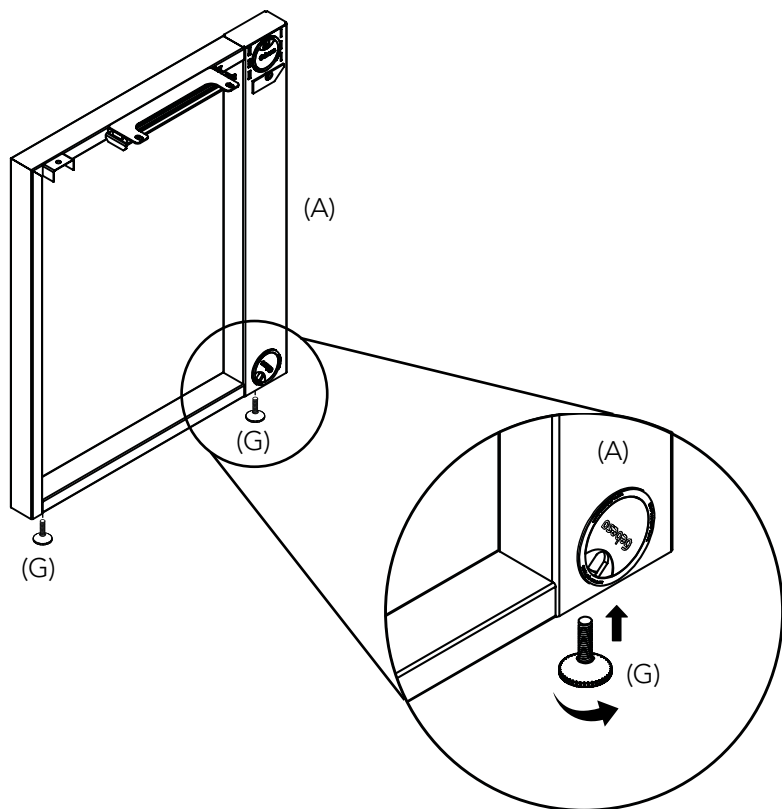

Adjust until completely balanced

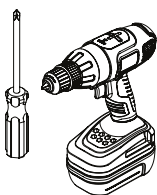

REQUIRED ASSEMBLY TOOLS  
NOT INCLUDED

2.

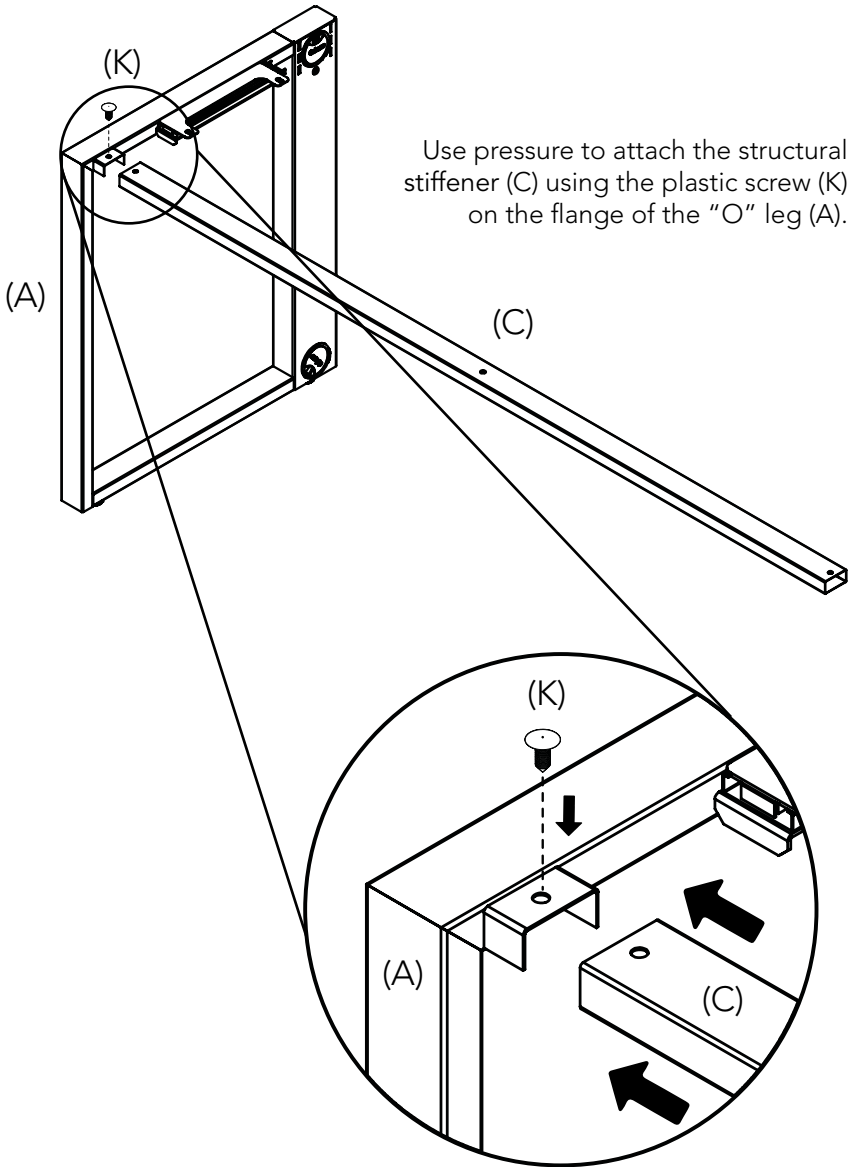

3.

Insert the front duct (B) in the leg's slots (A).

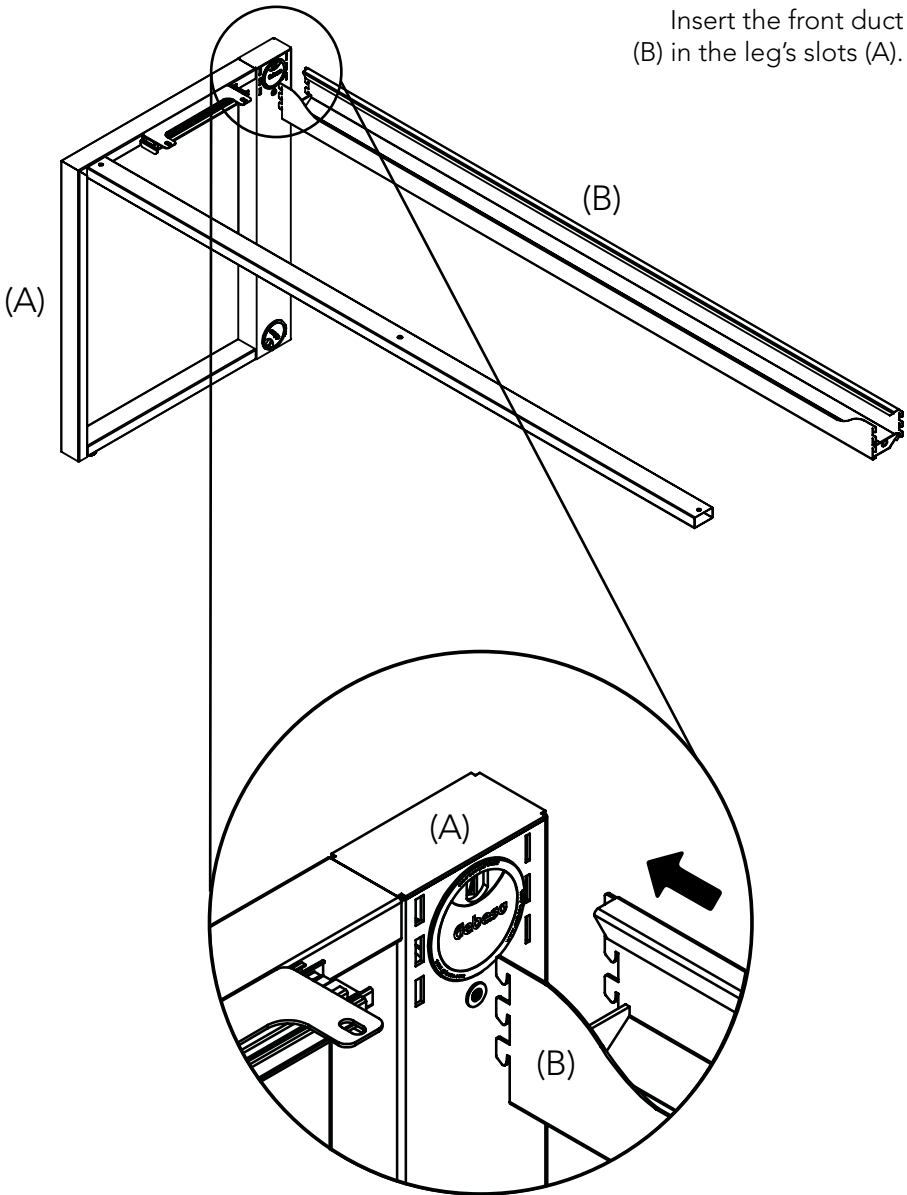

4.

Insert the lateral duct (E) over the previously assembled structure and repeat steps 2 and 3.

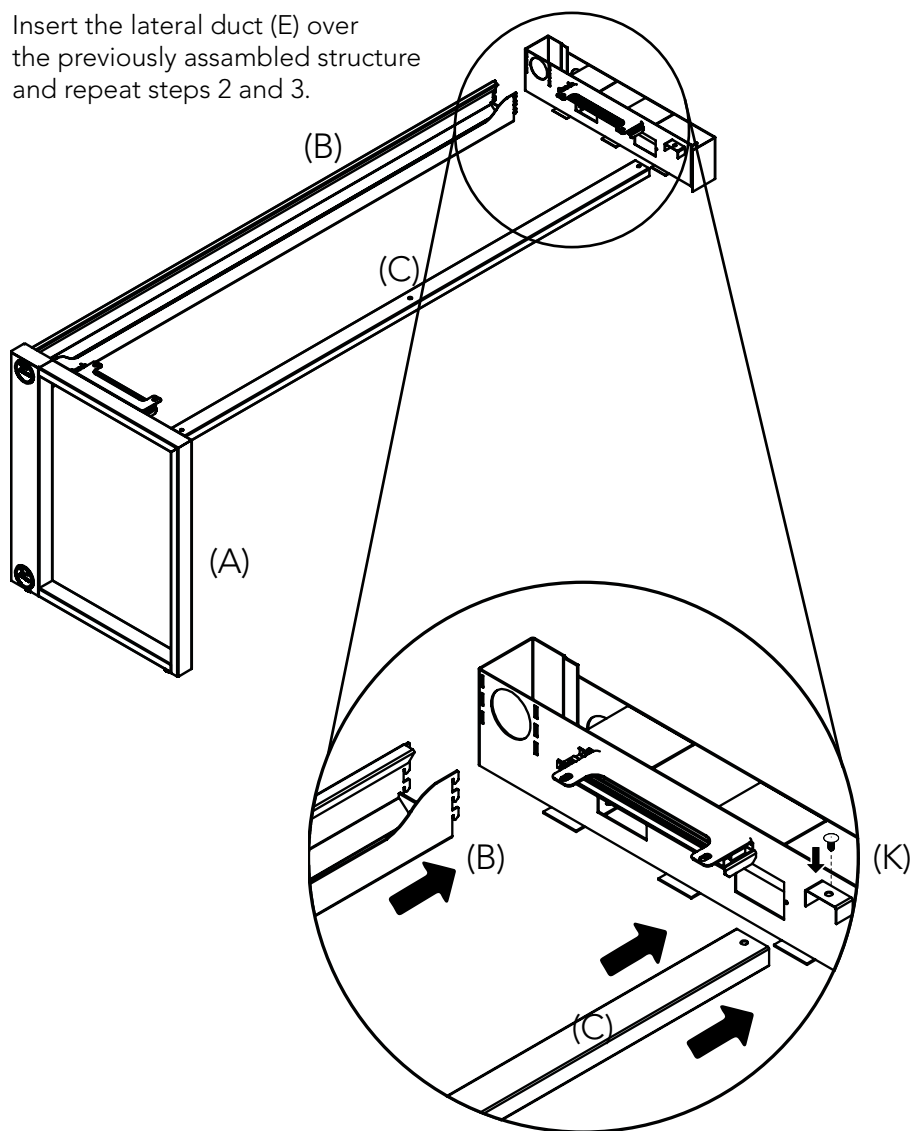

5.

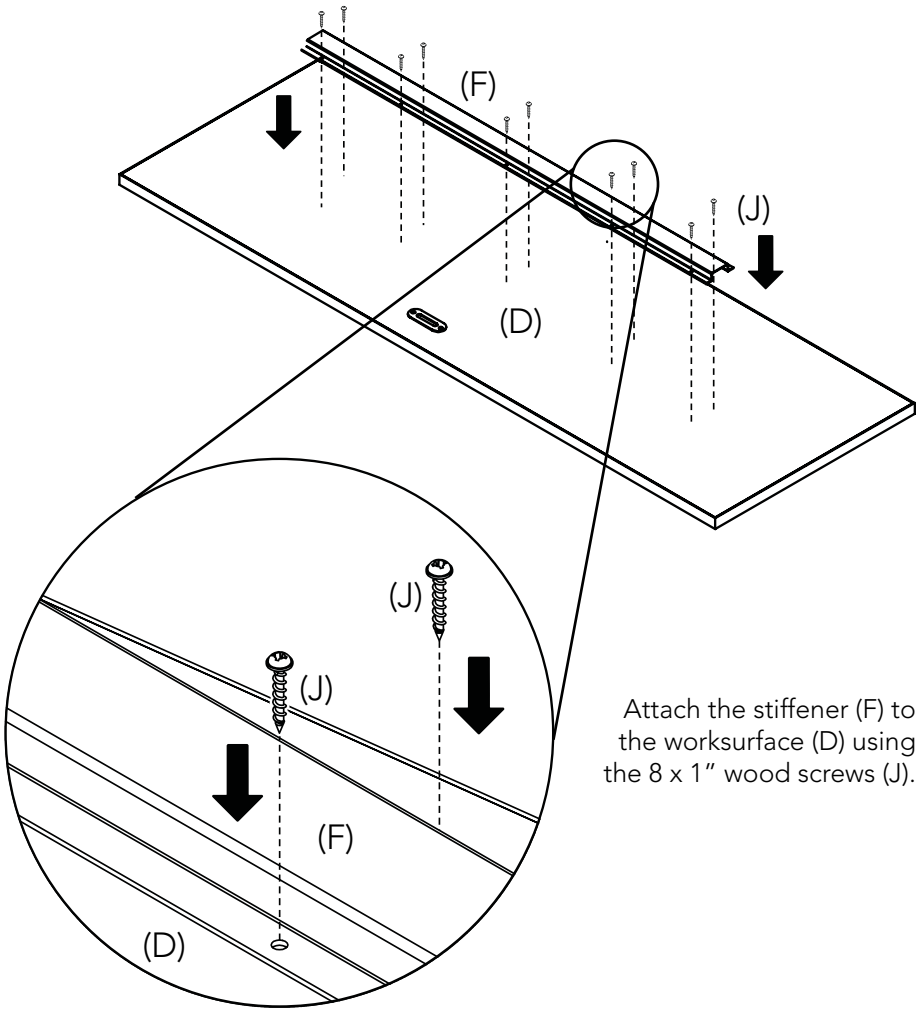

Attach the stiffener (F) to the work surface (D) using the 8 x 1" wood screws (J).



6.

Attach the worksurface (D) to the structure (BC) using the hand bolts (H) holding it from the sliding mechanism (E) attached to the "O" leg (A).

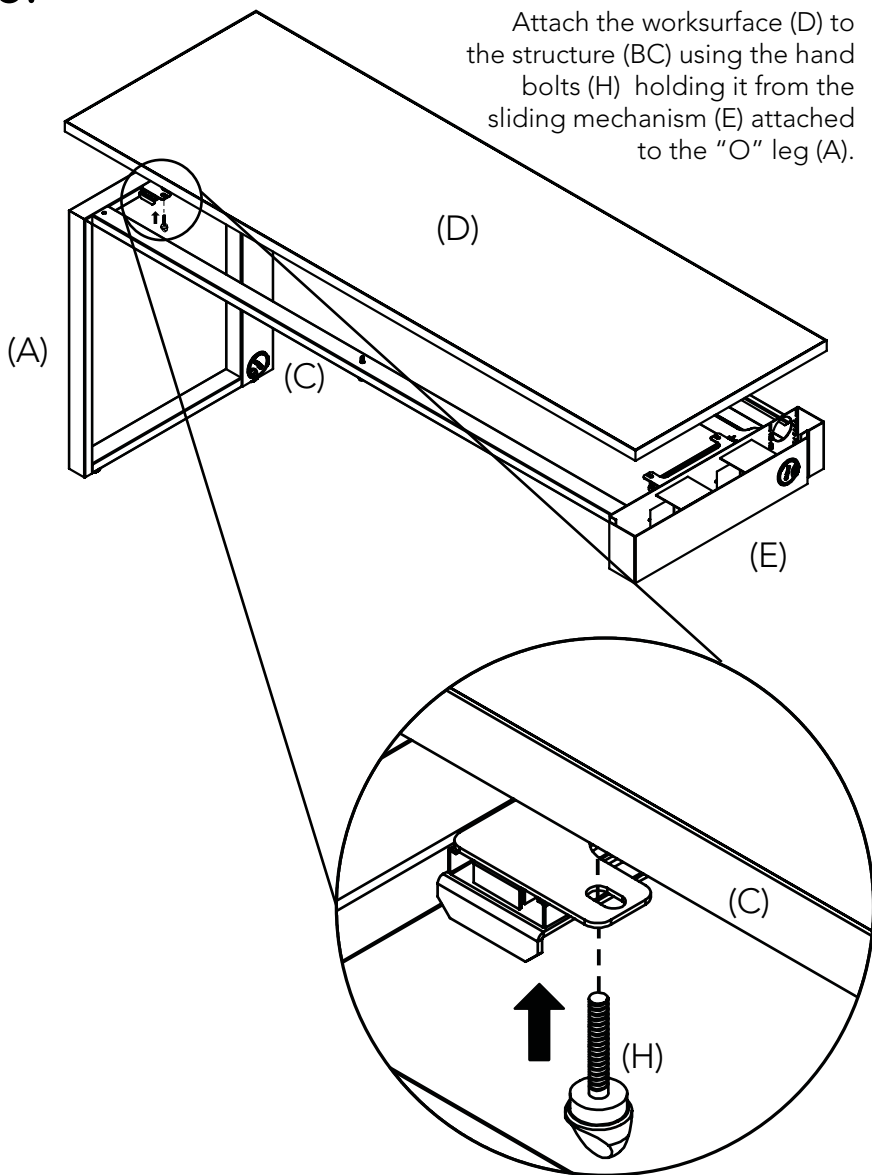

7.

Add the hand bolt (I) to the structure (C) to avoid the work surface (D) sliding.

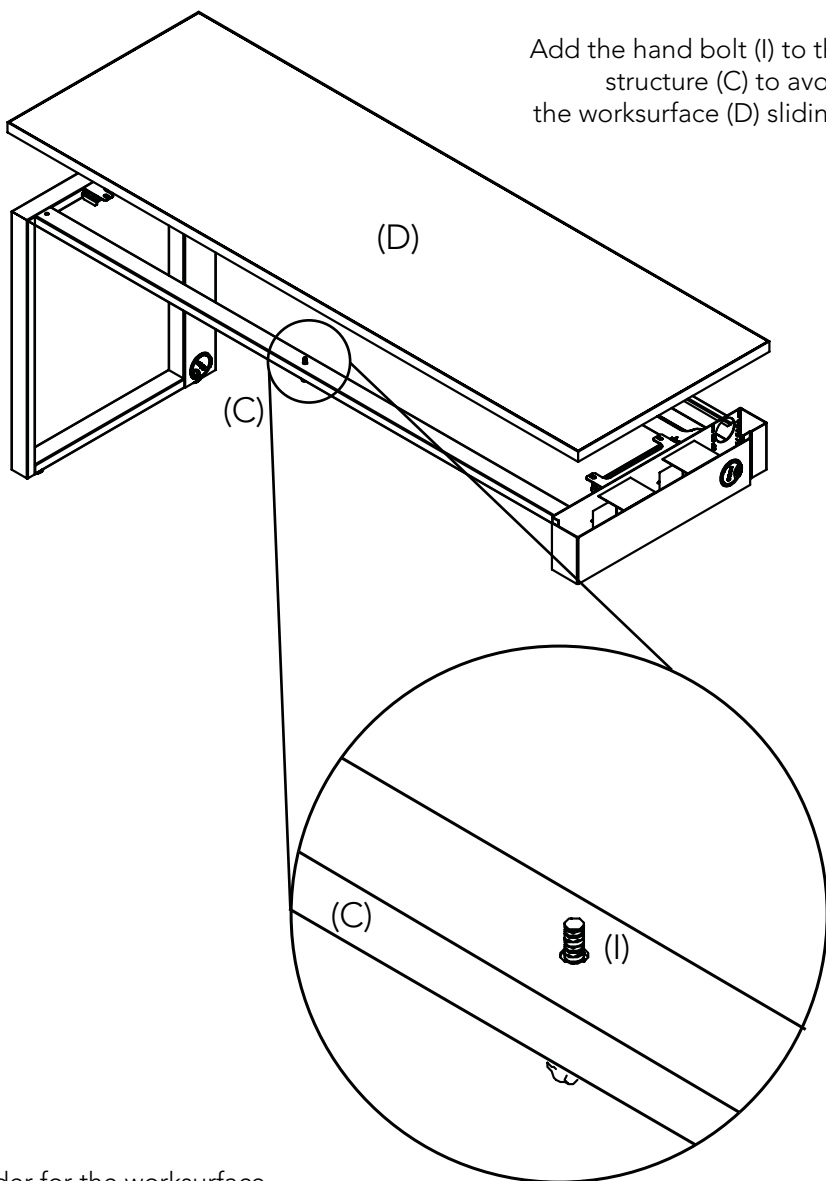

In order for the work surface to slide, loose the hand bolt.

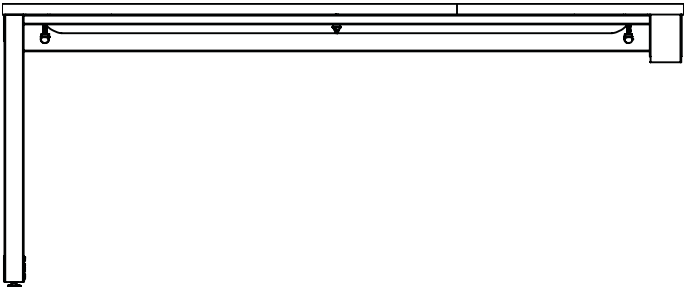
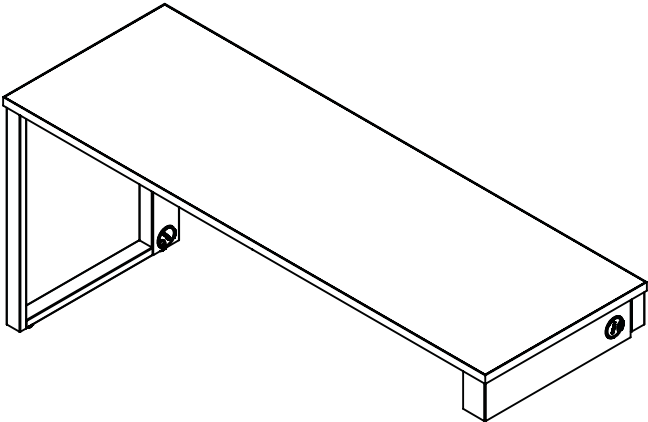

Front view

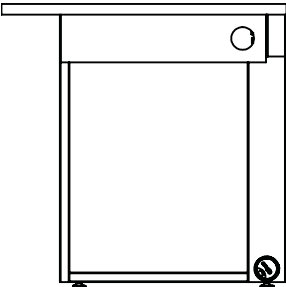

Side view

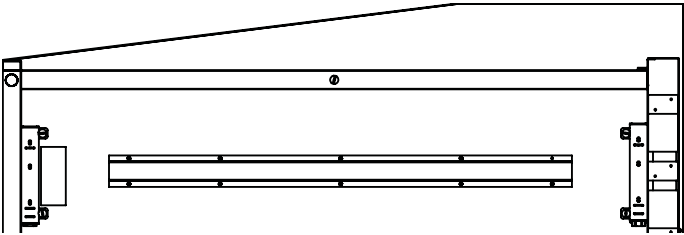

Bottom view

Questions?

Call Toll Free 1-844-2GEBESA or email [warranty@gebesa.com](mailto:warranty@gebesa.com)

**Gebesa**  
CREATING AMAZING SPACES